

# 5-STEP EASY LADDER® (\*with optional Deck Adaptor Skirts)

Model No. 0010-5

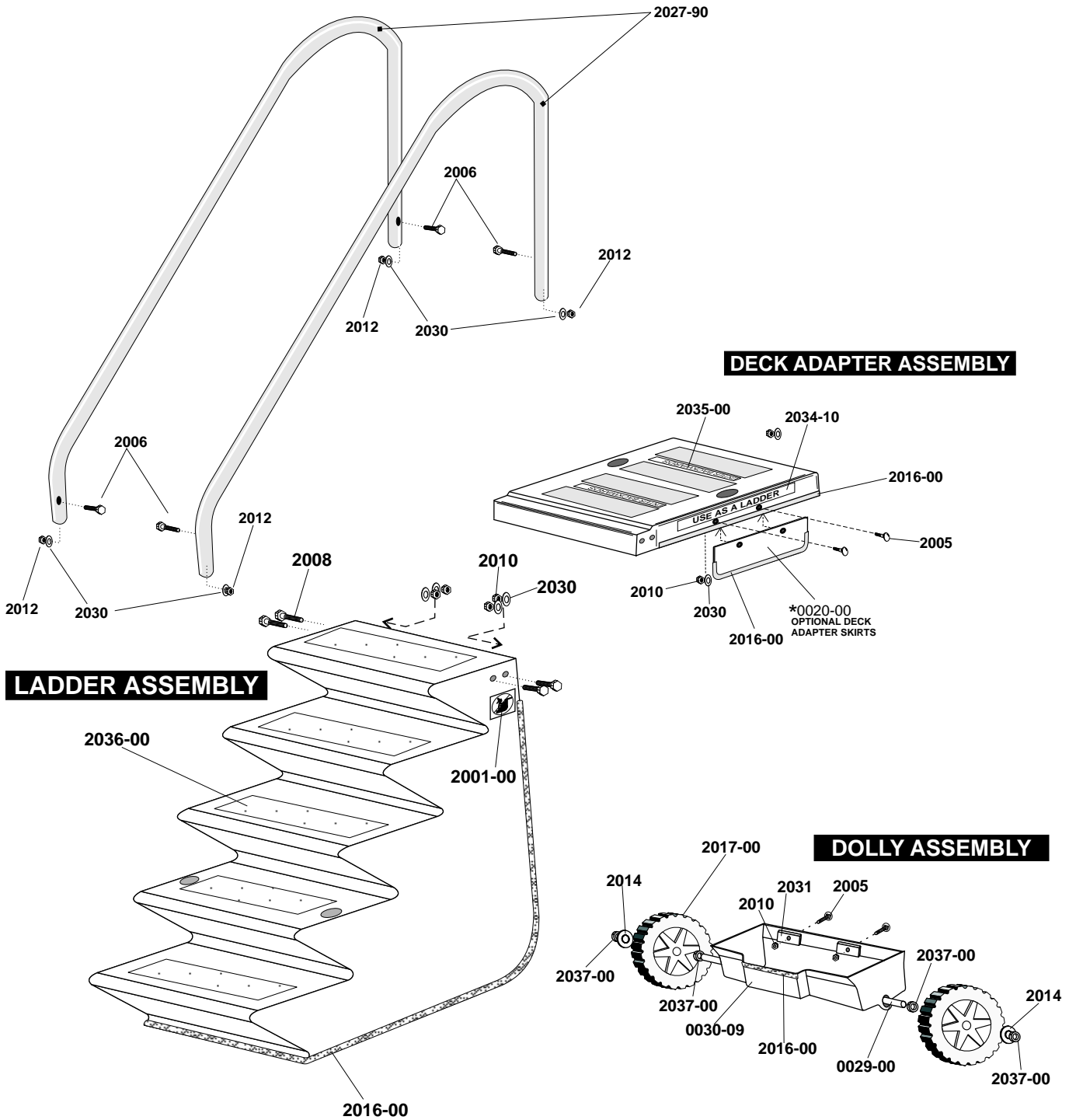

# 6-STEP EASY LADDER® (\*with optional Deck Adaptor Skirts)

MODEL No. 0010-6 (SAME FOR 7-STEP #0010-7)

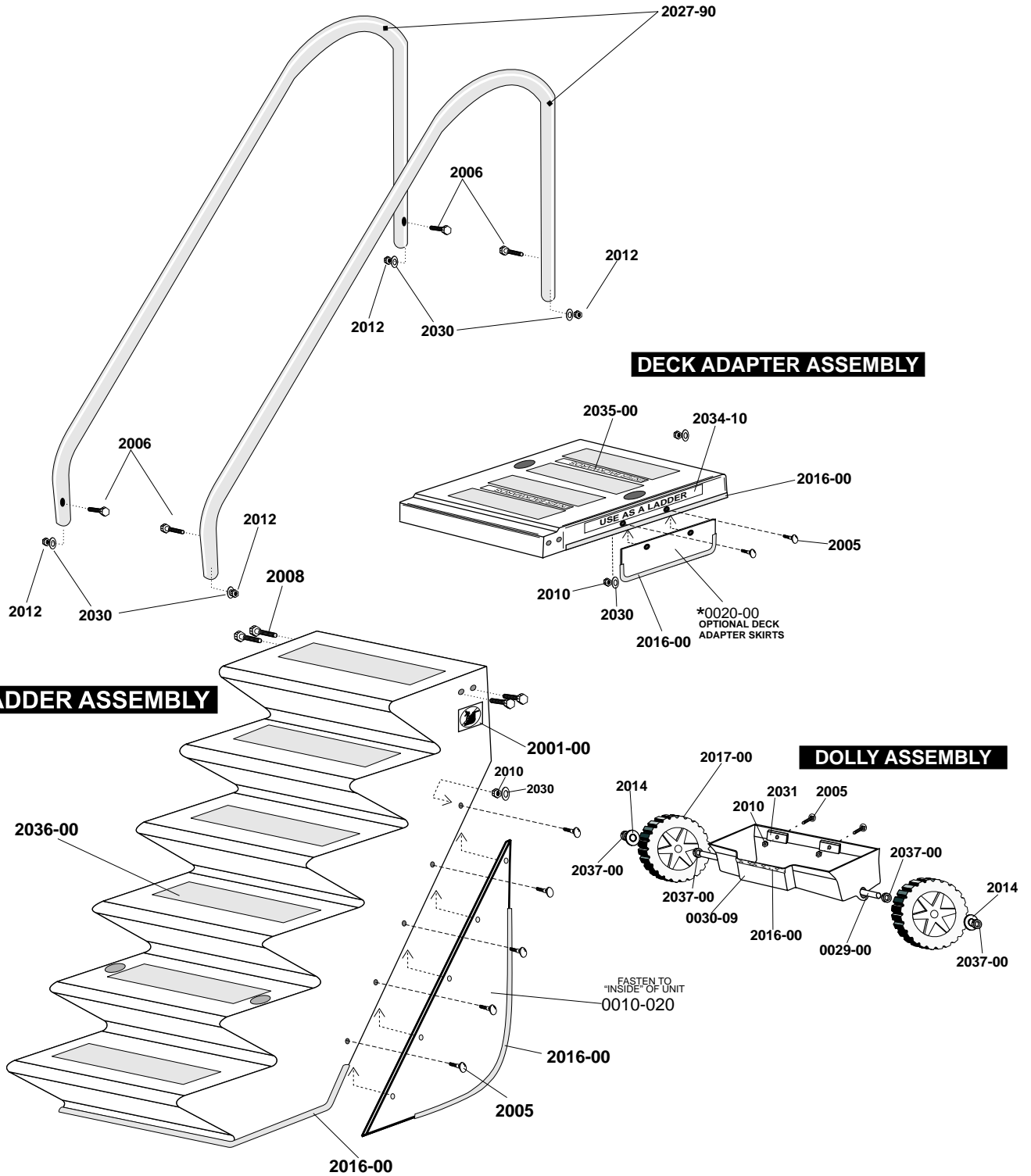

# EASY LADDER® (\*with optional Deck Adaptor Skirts)

MODEL No.'s 0010-5, 0010-6, 0010-7

<b>EASY LADDER®</b>			
REF No.	PART No.	DESCRIPTION	
1	2015-00	EASY LADDER DECAL KIT	INCLUDES ITEMS 1a-1f BELOW
1a.	2043-10	"EASY LADDER" DECAL	(1) REQUIRED PER LADDER
1b.	2034-10	"USE AS A LADDER" DECAL	(1) REQUIRED PER LADDER
1c.	2035-00	"ENTER BACKWARDS" DECAL	(3) REQUIRED PER LADDER
1d.	2001-00	"NO STEP" DECAL	(2) REQUIRED PER LADDER
1e.	2041-00	"WEIGHT LIMIT 300lbs." DECAL	(1) REQUIRED PER LADDER
1f.	2042-00	"WARNING: NON-SKID..." DECAL	(1) REQ. PER LADDER
2	2036-00	WHITE NON-SKID STEP COATING KIT	
3	2016-00	WHITE U-CHANNEL EDGE TRIM	INCLUDES ADHESIVE
4	0030-00	FIBERGLASS DOLLY	INCLUDES ITEMS 4a-4d BELOW
4a.	0029-00	STAINLESS STEEL DOLLY AXLE	
4b.	2017-00	8" PLASTIC DOLLY WHEEL	(2) REQUIRED PER DOLLY
4c.	2037-00	WHEEL COLLAR	(4) REQUIRED PER DOLLY
4d.	0030-09	FIBERGLASS DOLLY HOUSING	
5	2027-90	STAINLESS STEEL HANDRAIL	
6	0010-00	DECK ADAPTER ASS'Y	
7	0020-00	SIDE SKIRTS (priced per pair)	
<b>MISC. HARDWARE &amp; FASTENERS</b>			
9	2006	1-1/4" HEX BOLT, SST	
10	2012	5/16-18 LOCK NUT, SST	
11	2030	1/2" WASHER, SST	
12	2008	1-1/2" HEX BOLT, SST	
13	2010	5/16-18 HEX NUT, SST	
14	2005	5/16-18 CARRIAGE BOLT, SST	
15	2031	DOLLY BLOCK, ALUMINUM	
16	2014	1/2" X 1-1/4" FENDER WASHER, SST	

